



OVERSEAS TRADING SERVICES
O.T.S.



Generator Set Data Sheet

MPG600KVA

PK@50Hz 600KVA/480KW

Powered by



Main Features



DIESEL GENERATING SET



PERKINS
2806A-E18TAG1A



400/230V,
380/220V



3 phase
50 Hz



1500rpm



6CYLINDERS



62 LITRE



61 LITRE

Standby Power: 660 KVA - 528 KW

Prime Power: 600KVA - 480KW

Open Skid

Length (L) 380 cm
Height (H) 230 cm
Width (W) 155 cm
Weight 4400 kg
Daily Tank 515 L

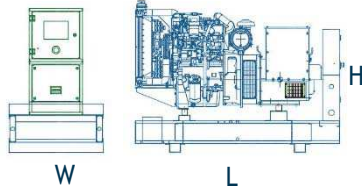

Sound Proof

Length (L) 565 cm
Height (H) 255 cm
Width (W) 185 cm
Weight 6400 kg
Daily Tank 820 L

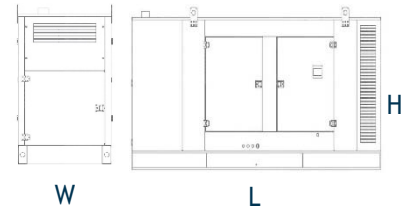

Acoustic pressure level @3m

79 dBA

ENGINE: PERKINS 2806A-E18TAG1A

Engine power output	522 kWm-700 hp
Cooling System	Water Cooled
Displacement / Capacity	18.1 Liter
No. of cylinders	6
Cylinder Arrangement	Vertical In line
Induction System	Turbocharged and air to air charge cooled
Bore and Stroke	145 x 183 mm
Cycle	4 stroke
Combustion System	Direct Injection
Compression Ratio	14.5:1
Rotation	Anti-clockwise, viewed on flywheel
Frequency and Engine Speed	50Hz & 1500rpm

Starting voltage	24V
Governor	Electronic
Oil capacity	62 Liter
Coolant capacity	61 Liter
24 V D.C. starter and charge alternator	
Replaceable fuel filter, oil filter and dry element air filter	
Cooling radiator and fan	
Starter battery (maintenance free)	
Fuel consumption at 100% load	123 L/hr.
Fuel consumption at 75% load	90 L/hr.
Fuel consumption at 50% load	61 L/hr.



OVERSEAS TRADING SERVICES
O.T.S.

MPG 600KVA

PK@50Hz 600kVA/480 kW

Powered by  Perkins

 LEROY SOMER

ALTERNATOR: LEROY SOMER

Rating	600KVA	Model	TAL047E
No. of bearing	1	Insulation class	H
Total Harmonic Content	<3.5% on load	Wires	6
		Excitation System	SHUNT
Ingress Protection	IP23	AVR Model	R150
Winding Pitch	2/3(n° 6)	Voltage Regulation	±1%
Over-speed	2250 mn ⁻¹		
Circuit Breaker Capacity	MCCB 1000Amps		

STANDARD CANOPY

Sound Level	79 dBA @ 3 meters in free space
Design	Rigid canopy base manufactured by black steel metal sheets welded on canopy body with internal Reinforcement and bolted on the body. 5 service doors with stainless steel door locks. Stainless steel heavy duty door hinges. Black steel canopy body – 2mm and 3mm treated with greasing phosphate and anticorrosion treatment with electro static power coating.
Connection	Flexible
Sound isolation	Rockwool with perforated sheets
Muffler	Muffler with rain cap

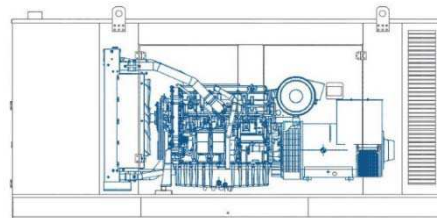
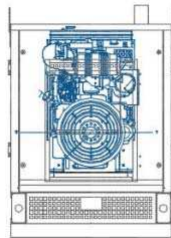

CONTROL (MONITORING) SYSTEM: DEEP SEA

Control panel model	DSE6010
	The DSE6010 is an Auto Start Control Module for single gen-set applications. It includes a backlit LCD display which clearly shows the status of the engine all the times. This module can either be programmed using the front panel or by using the DSE configuration suite PC software.
Metering and Alarm indications	<ul style="list-style-type: none"> • Generator frequency • Under-speed, Over-speed • Generators volts (L-L, L-N) • Generator current • Engine Oil pressure • Fail to start/ stop • Emergency stop • Failed to reach loading voltage / frequency • Engine coolant temperature • Fuel level (warning or shutdown) – Optional • Hours run counter • Battery volts • Charge fail • Low DC voltage • CAN diagnostics and CAN fail/ error

Gen-sets can be equipped with different control panels depending on usage, such as: DSE6020, DSE7310, DSE7320 or DSE8610 (Synchronization Panel)



OVERSEAS TRADING SERVICES
O.T.S.

MPG 600KVA

PK@50Hz 600kVA/480 kW

Powered by  Perkins

 LEROY SOMER

OPTIONAL EQUIPMENTS

ATS (Automatic Transfer Switch)	Alternator Anti-condensation Heater
Water Jacket Heater	Load Bank
Battery Charger	Electrical Fuel Level Sensor
Fuel Water Separator	Fuel Level Protection
Electrical Fuel Transfer Pump	Spare Parts
Battery Heater	Oil Heater

STANDARD SPECIFICATIONS

Warranty	All generating sets are covered under warranty policy for a period of 12 months in line with the manufacturers' warranty policy
Quality Standards	The equipment meets the following standards: BS4999, BS5514, IEC 60034, VDE0530, NEMA MG 1.22 and ISO 8528

Engine Filtration System
Air filter, Fuel filter, Oil filter. All filters have replaceable elements

Fuel System
On generating sets up to 650KVA, the base frame design is incorporated with an integral fuel tank with a capacity of approx... 8 hours running at average load. The tank is supplied with fill cap breather, fuel feed and return pipes to the engine and drain plug

Cooling Radiator
Radiator and cooling fan, complete with safety guards, designed to cool the engines at high ambient temperatures

Exhaust System
Heavy duty industrial exhaust silencer
Silencer noise reduction level: 22 (dB)
Maximum allowable back pressure: 10 (kPa)

Documentation
Operation & Maintenance manual, circuit wiring diagrams and commissioning / fault finding instruction leaflets are accompanied with the generator

Mounting Arrangement

Base Frame:

The complete generating set is mounted as a whole in a heavy duty fabricated steel base frame.

Coupling:

The engine and alternator are directly coupled by means of an SAE flange. The engine flywheel is flexibly coupled to the alternator rotor

Anti-Vibration Mounting Pads:

Anti-vibration pads are affixed between the engine/ alternator feet and the base frame thus ensuring complete vibration isolation of the rotating assembly

Safety Guards:

The fan & fan drive along with the battery charging alternator are safety guard protected for personnel protection

Factory Tests:

The generating set is load tested before dispatch. All protective devices control functions and site load conditions are simulated. The generator and its systems are checked before dispatch

Equipment Finishing:

All mild steel components are fully degreased and painted with powder coated paint to ensure maximum scuff resistance and durability

Assembled in facilities certified to ISO 9001

**OTS - Generators 3307, 1st Floor, Tayouneh, Facing Chobeiry Police Station
Chobeiry -Lebanon Phone: +961-1-271010, Whatsapp: +96181432901
info@ots-int.com - www.ots-int.com**