



OVERSEAS TRADING SERVICES  
O.T.S.



Generator Set Data Sheet

MPG1500KVA

PK@50Hz 1500KVA/1200KW Powered by



## Main Features



DIESEL GENERATING  
SET



PERKINS  
4012-46TAG2A



400/230V,  
380/220V



3 phase  
50 Hz



1500rpm



12 CYLINDERS



177 LITRE



210 LITRE

**Standby Power: 1656 KVA - 1325 KW**

**Prime Power: 1505KVA - 1204KW**

### Open Skid

Length (L) 540 cm  
Height (H) 255 cm  
Width (W) 220 cm  
Weight 9900 kg  
Daily Tank N/A

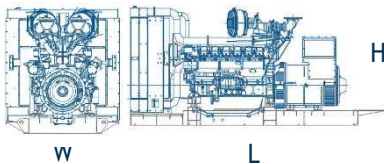

### Sound Proof

Length (L) 920 cm  
Height (H) 375 cm  
Width (W) 290 cm  
Weight 19500 kg  
Daily Tank N/A

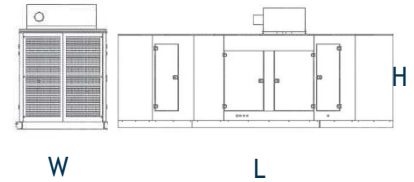

Acoustic pressure level @3m

85 dBA

## ENGINE: PERKINS 4012-46TAG2A

Engine power output	1267 kWm-1700 hp
Cooling System	Water Cooled
Displacement / Capacity	45.842 Liter
No. of cylinders	12
Cylinder Arrangement	60° Vee form
Induction System	Turbocharged and air to air charge cooled
Bore and Stroke	160 x 190 mm
Cycle	4 stroke
Combustion System	Direct Injection
Compression Ratio	13.6:1
Rotation	Anti-clockwise, viewed from flywheel end
Frequency and Engine Speed	50Hz & 1500rpm

Starting voltage	24V
Governor	Electronic
Oil capacity	177 Liter
Coolant capacity	210 Liter
<b>24 V D.C. starter and charge alternator</b>	
<b>Replaceable fuel filter, oil filter and dry element air filter</b>	
<b>Cooling radiator and fan</b>	
<b>Starter battery (maintenance free)</b>	
Fuel consumption at 100% load	301 L/hr.
Fuel consumption at 75% load	237 L/hr.
Fuel consumption at 50% load	162 L/hr.



## ALTERNATOR: LEROY SOMER

Rating	1500KVA	Model	LSA50.2L8
No. of bearing	1	Insulation class	H
Total Harmonic Content	<3.5%	Wires	6
		Excitation System	AREP
Ingress Protection	IP23	AVR Model	R448
Winding Pitch	2/3(n° 6S)	Voltage Regulation	± 0.5%
Over-speed	2250 mn <sup>-1</sup>		
Circuit Breaker Capacity	ACB 2500Amps		

## STANDARD CANOPY

Sound Level	85 dBA @ 3 meters in free space
Design	Rigid canopy base manufactured by black steel metal sheets welded on canopy body with internal Re-enforcement and bolted on the body. 8 service doors with stainless steel door locks. Stainless steel heavy duty door hinges. Black steel canopy body – 2mm and 3mm treated with greasing phosphate and anticorrosion treatment with electro static power coating.
Connection	Flexible
Sound isolation	Rockwool with perforated sheets
Muffler	Muffler with rain cap

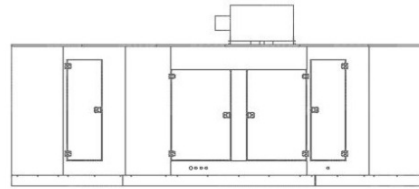
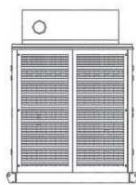

## CONTROL (MONITORING) SYSTEM: DEEP SEA

Control panel model	DSE6010 The DSE6010 is an Auto Start Control Module for single gen-set applications. It includes a backlit LCD display which clearly shows the status of the engine all the times. This module can either be programmed using the front panel or by using the DSE configuration suite PC software.	
Metering and Alarm indications	<ul style="list-style-type: none"> <li>• Generator frequency</li> <li>• Under-speed, Over-speed</li> <li>• Generators volts (L-L, L-N)</li> <li>• Generator current</li> <li>• Engine Oil pressure</li> <li>• Fail to start/ stop</li> <li>• Emergency stop</li> <li>• Failed to reach loading voltage / frequency</li> </ul>	<ul style="list-style-type: none"> <li>• Engine coolant temperature</li> <li>• Fuel level (warning or shutdown) – Optional</li> <li>• Hours run counter</li> <li>• Battery volts</li> <li>• Charge fail</li> <li>• Low DC voltage</li> <li>• CAN diagnostics and CAN fail/ error</li> </ul>

Gen-sets can be equipped with different control panels depending on usage, such as: DSE6020, DSE7310, DSE7320 or DSE8610 (Synchronization Panel)



OVERSEAS TRADING SERVICES  
O.T.S.

MPG 1500KVA PK@50Hz 1500kVA/1200 kW Powered by 



## OPTIONAL EQUIPMENTS

ATS (Automatic Transfer Switch)	Alternator Anti-condensation Heater
Water Jacket Heater	Load Bank
Battery Charger	Electrical Fuel Level Sensor
Fuel Water Separator	Fuel Level Protection
Electrical Fuel Transfer Pump	Spare Parts
Battery Heater	Oil Heater

## STANDARD SPECIFICATIONS

Warranty	All generating sets are covered under warranty policy for a period of 12 months in line with the manufacturers' warranty policy		
Quality Standards	The equipment meets the following standards: BS4999, BS5514, IEC 60034, VDE0530, NEMA MG 1.22 and ISO 8528		
Engine Filtration System	Air filter, Fuel filter, Oil filter. All filters have replaceable elements		
Fuel System	On generating sets up to 650KVA, the base frame design is incorporated with an integral fuel tank with a capacity of approx... 8 hours running at average load. The tank is supplied with fill cap breather, fuel feed and return pipes to the engine and drain plug	Mounting Arrangement	<p><b>Base Frame:</b> The complete generating set is mounted as a whole in a heavy duty fabricated steel base frame.</p> <p><b>Coupling:</b> The engine and alternator are directly coupled by means of an SAE flange. The engine flywheel is flexibly coupled to the alternator rotor</p> <p><b>Anti-Vibration Mounting Pads:</b> Anti-vibration pads are affixed between the engine/ alternator feet and the base frame thus ensuring complete vibration isolation of the rotating assembly</p> <p><b>Safety Guards:</b> The fan &amp; fan drive along with the battery charging alternator are safety guard protected for personnel protection</p>
Cooling Radiator	Radiator and cooling fan, complete with safety guards, designed to cool the engines at high ambient temperatures		
Exhaust System	Heavy duty industrial exhaust silencer Silencer noise reduction level: 22 (dB) Maximum allowable back pressure: 10 (kPa)		
Documentation	Operation & Maintenance manual, circuit wiring diagrams and commissioning / fault finding instruction leaflets are accompanied with the generator	Factory Tests:	The generating set is load tested before dispatch. All protective devices control functions and site load conditions are simulated. The generator and its systems are checked before dispatch
		Equipment Finishing:	All mild steel components are fully degreased and painted with powder coated paint to ensure maximum scuff resistance and durability

Assembled in facilities certified to ISO 9001

**OTS - Generators 3307, 1st Floor, Tayouneh, Facing Ghobeiry Police Station  
Ghobeiry -Lebanon Phone: +961-1-271010, Whatsapp: +96181432901  
info@ots-int.com - www.ots-int.com**